

SAFETY SOLUTIONS

- CAMERAS
- BACK UP ALARMS
- CARGO CONTROL
- LIGHTING
- SAFETY ESSENTIALS



**UltraFlex Series
Flexible Directional
Warning Light**
[PART# ED3794AW](#)



**800 Series
Back Up Alarm
Surface Mount**
[PART# 850N](#)



**Backup Camera
System W/
Night Vision**
[PART# 8883000](#)



**EZ Load Binder
Self Contained
Chain Binder**
[PART# 50140-10](#)



STAY COMPLIANT & SAFE ON THE ROAD WITH OUR BEST SELLERS

Our website just got an upgrade!
Check the back of the brochure for more details.

SADLERPOWERTRAIN.COM

Cedar Rapids
800.383.8238

Davenport
800.383.4213

Dubuque
800.747.0752

Waterloo
800.373.3035



LIGHTING

BEACON WARNING



7965 Series Pulse II

[PART# 7965A](#)

12-24VDC operation and
11 flash patterns



EB7180 Series LED

[PART# 7180A](#)

Amber
2.3" Height



L10 Series LED

[PART# L10HAP](#)

Amber
High Dome



Wireless Rechargeable Amber Led

[PART# TLED-W12](#)

Remote included
Battery Lasts Up To 12 Hrs

MINI LIGHTBARS



5580 Series Reflex

[PART# 5580A](#)

15" Length
Amber



Octagonal

[PART# 8891060](#)

15" Length
Amber



Rectangular Multi-Mount

[PART# 8891040](#)

11" Length
Amber



R1 Responder Low Profile Super LED

[PART# R1LPPA](#)

Amber

LIGHTING

WORK LIGHTS



**Ultra Bright Wide
Square Flood**
[PART# 1492128](#)
4.5'' Height
4320 RAW Lumens



**EW2101 Equinox
Series Square**
[PART# EW2101](#)
5'' Height
1650 RAW Lumens



**Round Spot Beam LED
W/ Advanced Heatsink**
[PART# TLED-UX2](#)
5'' Height
2000 RAW Lumens



**Oval Super Powered
Flood Led**
[PART# TLED-U29](#)
6''
6000 RAW Lumens

OTHER LIGHTING OPTIONS



**11 Series RefleXL
Narrow LED**
[PART# 11-024CA-E](#)
24'' Length
Amber



**3400 Series
Safety Director**
[PART# 3410A](#)
48.1'' Length
15' Cable
Amber



**ED3802 Series
Surface Mount**
[PART# ED3802AW](#)
4.75'' Length
Amber & White



**ED9015 Series
Surface Mount**
[PART# ED9015AW](#)
1.5'' Length
Amber & White

CARGO CONTROL

OVERSIZE LOAD



**18" X 84" Oversize
Load Banner**
[PART# 49894-13](#)

WIDE LOAD



**18" X 84" Mesh Wide
Load Banner**
[PART# 49894-14](#)



**Grade 70 3/8" X 20'
Chain Assembly
With Clevis Hooks**
[PART# 45881-11-20](#)
6,600 Lbs Working
Load Limit



**1/2" To 5/8" Ratchet
Load Binder**
[PART# 45943-23](#)
13,000 Lbs Working
Load Limit



**4" X 30' Winch
Strap W/ Flat Hook**
[PART# 43795-10-30](#)
5,400 Lbs Working
Load Limit



**2" X 27' Ratchet Strap
W/ Flat Hooks & Long/
Wide Handle**
[PART# 45982-10](#)
3,333 Lbs Working
Load Limit



**Mini Ratchet Strap
Tie Down**
[PART# 43887-10 16'](#)
[PART# 43887-11 20'](#)
1,000 Lbs Working
Load Limit



**Standard Ergo
360° BAR**
[PART# 50015-10](#)
Bar Can Be Rotated A Full
360° To Gain Optimal
Leverage Without
Removal

CAMERAS/BACK UP ALARMS

CAMERAS



**Smart Wifi/GPS
Dash Cam**
[PART# SC200](#)
QHD + 1600P Resolution
3" LCD Display



**Pinnacle Touch Screen
Wifi/GPS Dash Cam**
[PART# TDPINNACLE1](#)
4K
4" LCD Display



GEMINEYE Wired Camera
7" LCD Color
[PART# K7000B](#)
CMOS LEDs: 18
Expandable Camera: 2



GEMINEYE Wired Camera
5.6" LCD Color
[PART# EC5603-K](#)
CMOS LEDs: 11
Expandable Camera: 3

BACK UP ALARMS



**500 Series
Surface Mount**
[PART# 530](#)
102 DB
12-24V



**600 Series
Smart Alarm**
[PART# SA901N](#)
Self Adjusting
82-107 DB
12-24V



**Warning Alarm
Dual Function**
[PART# DF532](#)
Dual Function
102 DB
12-24V



**Dual Function
Light Duty**
[PART# 19-2115](#)
Self Adjusting
102 DB
12-24V

SAFETY ESSENTIALS



Grote

Red / Silver
Conspicuity Tape

[PART# 41160](#)

Red/Silver 2" x 150' Roll



Buyers
PRODUCTS COMPANY

Heavy Duty Rubber Wheel
Chock W/ Chain Eye

[PART# WC1086](#)

Resists Oil, Rust, Salt, Sun Too
Chain eye for easy storage



Truck-lite

Warning Triangle Set

[PART# 798](#)

3-Piece 16.25" Signal-Stat
Foldable Free-Standing



SIRCO
Safety Products, Inc.

18" X 18" Red Jersey
Flag W/ Bungee

[PART# WF1007BR](#)

18" X 18" Orange Jersey
Flag with 3/4" X 30" Dowel
[Par# Wf1001DO](#)



Buyers
PRODUCTS COMPANY

4" Round Rechargeable
LED Road Strobe/Flare

[PART# 8891016](#)

Amber



Kidde

Fire Extinguisher

[PART# 440161MTLK](#)

2.5 LB BC

[PART# 466425](#)

5 LB ABC



TRUX
ACCESSORIES

3 Bell Train Horn

[PART# THORN-1](#)

130-135 DB

DUAL-MODE
AM/FM



Cobra

Cobra 29 LTD

[PART# CCBP29LT101](#)

4 Watts of power

40 channels

Dual-mode AM/FM

SAFETY ESSENTIALS

Truck-Lite



7" X 16"
Pyramid Style
West Coast
[PART# 97861](#)

Silver Stainless Steel
[PART# 97809](#) - Heated

Truck-Lite



6" X 16"
Box Style
West Coast
[PART# 97860](#)

Silver Aluminum

Truck-Lite



8.5"
Round Silver
Steel Convex
[Part# 97803](#)

Universal Mount

Truck-Lite



7.5" X 10.5"
Flat Silver
Stainless Steel
[Part# 97662](#)

5" Elbow
[PART# 97661](#) - 4" Elbow

clearplus
WINDSHIELD WIPERS



Premium Wiper Blades

16" – [PART# 20161](#)

18" – [PART# 20181](#)

19" – [PART# 20191](#)

20" – [PART# 20201](#)

21" – [PART# 20211](#)



LED AirGuard
SET & GO Tire Pressure Monitoring System

LED Air Guard Tire Pressure Monitoring System Valve Caps

[PART# RW-PPK-0402 – 4 PACK](#)

[PART# RW-PPK-0403 – 6 PACK](#)

Starts Flashing Led Red
If Tire Pressure Drops 5 To 10 PSI
Designed To Fit Trucks, Semis,
Trailers, Motor homes & Other
Commercial Vehicles

Schumacher



Rechargeable AGM Jump Starter for Gas, Diesel Vehicles
[PART# SJ1330](#)

Engine Compatibility
8.0L Gas, 6.0L Diesel
Outlets

12V DC accessory &
2.0A USB

Air Compressor
Analog 150 PSI
Peak Output Current
1000 Amps

Product Dimensions

SAFETY SOLUTIONS



SADLER
POWER TRAIN
TRUCK PARTS & SERVICE



NEW WEBSITE:

Updated navigation, detailed product info, and more!
In celebration of our 50 remarkable years, we've kicked off a new website with our customers in mind. Enjoy a shopping experience that's efficient, quick, and tailored to your needs.



Dynamic Search Suggestions

Get instant results as you type, accessing our inventory in real-time.



Enhanced Product Information

Make informed buying decisions with detailed product images and attributes.



Upgraded Cross Reference

Access 250,000+ enhanced cross references, with 75% of our parts having at least one reference.



Live Chat

Connect in real-time through live chat for quick assistance. Share pictures of parts for identification or check order status.



Account Management

View invoices, credits, and core returns on your dashboard.



Personalized Products

See products matching your interests based on clicks, purchases, and reviews.

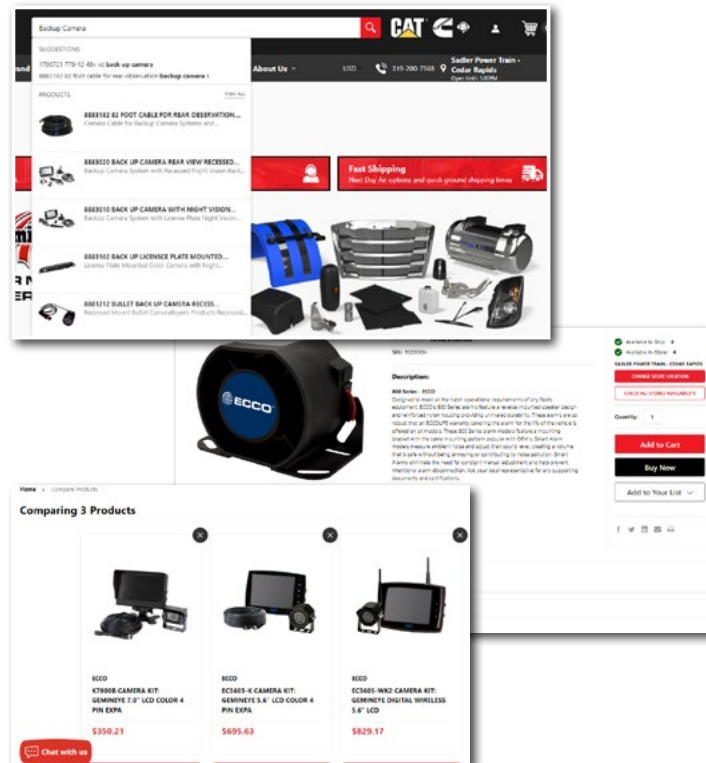

24/7 Online
Parts Counter



Over \$11 million
In-Stock Parts



Everyday
Delivery

Cedar Rapids
800.383.8238

Davenport
800.383.4213

Dubuque
800.747.0752

Waterloo
800.373.3035

SADLERPOWERTRAIN.COM