

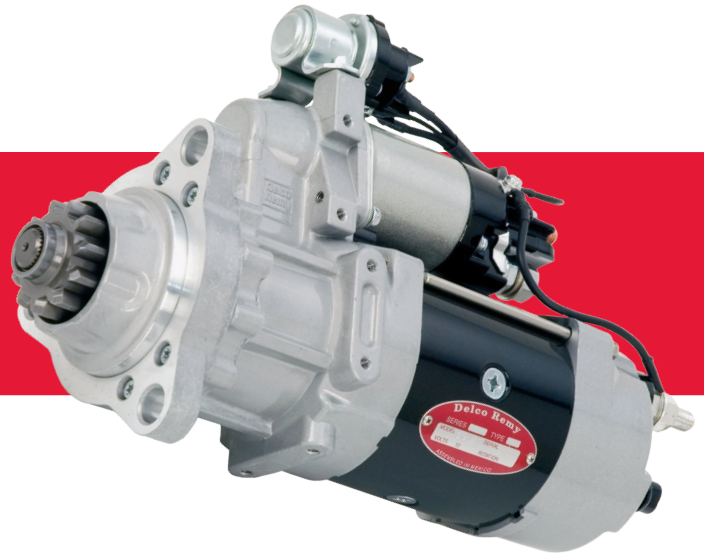

# 39MT™

## HEAVY DUTY GEAR REDUCTION STARTER



CRANKS UP TO  
**30% FASTER**  
THAN THE COMPETITION

### FEATURES & BENEFITS

- New service models come standard with **Over Crank Protection (OCP)**. OCP monitors the internal temperature and prevents thermal damage to the starter by preventing overcranking.
- These models feature an **Integral Magnetic Switch (IMS)**. IMS reduces voltage drop and ensures the solenoid receives the maximum available voltage in any starting condition.
- **Rotatable flange models** were designed specifically to improve service flexibility and part number consolidation. They easily replace competitive units and provide full industry application coverage.
- **Warranty for All Makes models:**  
3 year/unlimited miles  
(Applicable to U.S. and Canada only)

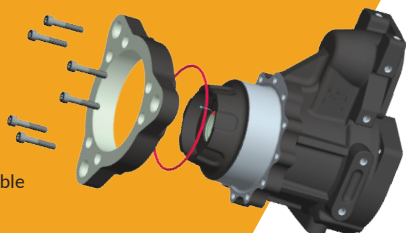

Rotatable  
Flange  
Design

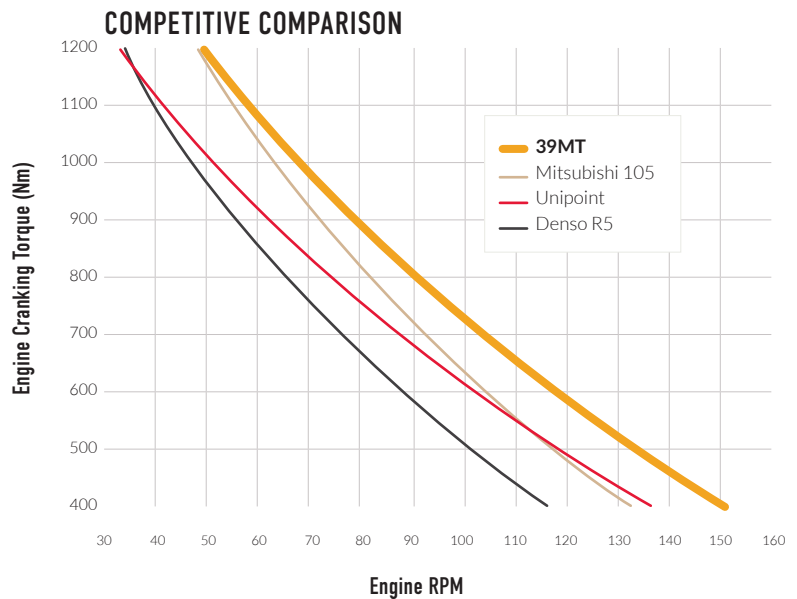

### SPECIFICATIONS

Engine Size	12V up to 16 Liters, 24V up to 16 Liters
Rotation	Clockwise
Mounting	12V: SAE #1, SAE #3; 24V: SAE #3
Pinion Data	11 Tooth, 6-8 Pitch; 12 Tooth, 8-10 Pitch; 12 Tooth, Mod 3-metric
Output	12V peak at 7.3kW, 24V peak at 9.0kW
Weight	14 kg/30.8 lbs.
Diameter	114 mm/4.5 inches
Heavy Duty Drive	Electrical Soft-Start Engagement System Overrunning Clutch

OEM	ENGINE	OE	REMAN	ALL MAKES		PINION PITCH/TEETH	COMPETITIVE CROSS REFERENCES		
				NEW SERVICE	ROT. FLANGE				
Freightliner Sterling Western Star	MBE 4000	19011525, 8200082, 8200660, 8200687	8300008	8200287 <sup>1</sup>	N/A	Mod 3 - 12 tooth	MIB971179, MIB971179FL, FL1179		
		19011514, 8200084, 8200624, 8200690	8300013						
	Cummins ISC, ISL	19011526, 8200081, 8200659, 8200688, 8200783	8300007	N/A	8200433	8/10 - 12 tooth	N/A		
		19011517, 8200087, 8200625, 8200691	8300015						
	CAT C15, Cummins ISX, ISM, Detroit S60	19011521, 8200090, 8200091, 8200661, 8200686, 8200662, 19011516, 19011518, 19011529, 19011530, 8200623, 8200627, 8200628, 8200692	8300009	8200289	8200308	6/8 - 11 tooth	MIB970975, MIB970975FL, FL0975, MIB970777, MIB970777FL, FL0777, FL0579, D616005003, D616002004		
		61000944, 61000945	N/A						
Cummins ISX12 & ISX15 with Dual Input IMS DD 13/15/16 2015 and older DD 13/15/16 2016 and newer Cummins ISX, ISM, CAT C13, C15	8200329, 8200671, 8201022	8300084 <sup>2</sup>	N/A	61013765	Mod 3 - 12 tooth	N/A			
	8201004, 61000704	61002714					61008898	N/A	
Navistar	DT466, DT570, HT570, Maxxforce DT, 9, 10	8200050, 8200091, 8200604, 8200605	8300009	8200289	8200308	6/8 - 11 tooth	3815734C91, IN1478, D616005003, D616002004		
		8200081, 8200659, 8200218, 8200635, 8200219, 8200664, 8200360, 8200672, 8200384, 8200639, 8200857, 8200606	8300007					N/A	8200433
Kenworth Peterbilt	MaxxForce 11/13 Detroit Diesel Series 60 (S60), CAT C9, C10, C11, C12, C13, C15, Cummins ISX15, ISM	8200050, 8200090, 19011529, 8200104	8300009	8200290	8200308	6/8 - 11 tooth	D61-6002-004, D61-6002-008, PC0979, PC1479, PC1879 M983579, D616005003, D616002004		
		8200405 <sup>3</sup> , 8200741 <sup>3</sup> , 8200742 <sup>3</sup>	N/A					8200742 <sup>3</sup>	N/A
		8200457, 8200808 <sup>3</sup> , 8200763 <sup>3</sup>	N/A					N/A	8200433
Mack	Mack E7	8200793	N/A	8200288	8200308	6/8 - 11 tooth	D61-6002-010		
		19011500, 19011505, 19011531, 8200037	8300020						
	Mack MP7	8200223, 8200612, 8201074, 61003774	8300059	8200468	8200308	8/10 - 11 tooth	21001797, MK1075		
		8200214, 8200572, 8200611, 8200910, 8200417	61002699					8201100	N/A
	Mack MP8 2012 and older Mack MP8 2013 and newer	8201076, 61003776	8300061	8200469 <sup>4</sup>	8200308	8/10 - 12 tooth	21045969		
		8200182, 8200610, 8201072, 61003772	8300007					N/A	8200971
Cummins ISL, ISL-G	8200768, 8200625, 8201080, 8201081, 61003780, 61003781, 8200915, 8201082, 61003782, 8200793 <sup>4</sup>	N/A	N/A	8200971	8/10 - 12 tooth	N/A			
	8200915, 8201082, 61003782, 8200793 <sup>4</sup>	N/A							
Volvo	Cummins ISX, ISM	19011516, 19011517, 19011530, 8200091, 8200662, 8200319, 8200820, 8201078, 8201079, 61003778, 61003779	8300009	8200289	8200308	6/8 - 11 tooth	20851006, VV0776, VV0977, D616005003, D616002004		
		8200223, 8200612, 8201073, 61003773	8300059					8200468	N/A
	Volvo D11	8200058, 8200186, 19011515	8300004	8200291	8200308	8/10 - 12 tooth	VV0279		
		8200214, 8200572, 8200611, 8200909, 8200417	61002699					8201100	N/A
	Volvo D12	8200214, 8200572, 8200611, 8200909, 8200417	61002699	8201100	8200308	8/10 - 12 tooth	22398223		
		8201075, 61003775	N/A					61022931	N/A
Volvo D13-TC (turbo compound)	23877710, 24146861, 22164944, 23877708, 22172959, 61025001, 61025002, 24427887, 24427888	N/A	61022931	8200308	8/10 - 12 tooth	M009TA0276ZX, M009TA0277ZX			
Volvo D16	8200182, 8200610, 8201071, 61003771	8300061	8200469 <sup>4</sup>	8200308	8/10 - 12 tooth	21001825, VV1979			
Cummins ISX 12G	8200960, 8201083, 61003783, 8200793 <sup>4</sup>	N/A	N/A	8200971	6/8 - 11 tooth	N/A			
Autocar	Cummins ISX, ISM	8200091, 19011530	8300009	8200289	8200308	6/8 - 11 tooth	D616005003, D616002004		
	Cummins ISC, ISL, ISL-G	8200218, 8200219	8300007	N/A	8200433	8/10 - 12 tooth	N/A		
Prevost Bus	24V Detroit S60	N/A	N/A	N/A	8200330	6/8 - 11 tooth	510752, PV2479		
MCI Bus	24V Detroit S60, Cummins ISM, CAT C12, C13	N/A	N/A	N/A	8200330	6/8 - 11 tooth	71-01-1008, MC2378		
Various 24V	CAT C12, C13, C15, Cummins ISM, ISX, N14, Detroit S60, Mack E7				8200330	6/8 - 11 tooth	AM84479, PV2479, PC83579, MC2378, M105732, M105R3532SE		
	Cummins ISC & ISL, Navistar DT466 & DT530, Volvo D12				8200435	8/10 - 12 tooth	AM84579, M105723, M105R3523SE, M105R3541SE		
	DD 13/15/16 2015 and older				8200436	Mod 3 - 12 tooth	AM85679, PV83379, PV84379, AM86979, M105724, M105R3524SE		

<sup>1</sup> Replacement may mount the engine with solenoid facing down by design. <sup>2</sup> Replaces reman P/N 8300058. <sup>3</sup> Integrated OCP. <sup>4</sup> No OCP.



For Customer Service or Technical Assistance call 800-372-0222

01 | 2024  
DELCOREMY.COM

